

**SEIBU FASTENERS, INC.**

10370 Slusher Dr. Unit 11 &amp; 12

P.O. Box 4145

Santa Fe Springs, CA. 90670

Phone (562) 941-3348

Fax (562) 944-3621

TOLL FREE (866) 497-5344

**STEEL, DIN 988 SHIM WASHERS, YELLOW ZINC PLATED.**

1126	M10X 16 X 0.5	0.89#
------	---------------	-------

**STEEL, DIN 9021 FENDER WASHERS, ZINC PLATED.**

2399	M3X 9 X 0.8	0.77#
2400	M4X 12 X 1.0	1.69#
3698	M5X15X1.4	4.35#
1124	M6X 18 X 1.6	6.14#
2402	M6X 20 X 1.6	7.20#
1125	M12X 40 X 2.5	50.15#

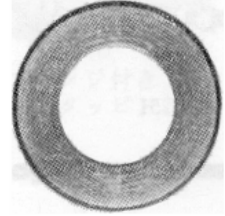
**STEEL, JASO F-203-68 SPRING SNAP PIN, ZINC PLATED. (SNAP)**

1211	D4X 60	0.48#
1212	D6X 100	0.88#
1213	D8 X 110	2.11#
1214	D10X 120	2.97#
1215	D12X 140	3.35#

**STEEL, JIS B1196 TYPE 1A HEXAGON WELD NUTS W/ PILOT, PLAIN. (WELD)**

2397	M4-0.7	6.82#
6214	M6-1.0X 13 X 6	10.74#

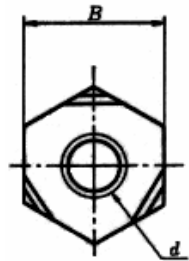
**STEEL, JIS B1181 (DIN 934-8) TYPE 2 HEXAGON NUTS, ZINC PLATED.**

1184	M2-0.4 X 4 X 1.6	0.31#
1185	M2.5 X 5 X 2	0.62#
1233	M2.6	0.60#
1186	M3-0.5 X 5.5 X 2.4	0.84#
1187	M3.5-0.6 X 6 X 2.8	0.95#
1188	M4 X 7 3.2	1.79#
1189	M5-0.8	2.71#
1190	M6-1.0 X 10 X 5	5.50#
2182	M7-1.0 X 5.5 X 11	5.92#
1191	M8-1.25 12 AF	11.00#
1192	M8-1.25 13 AF	11.44#
4926	M10-1.25 14 AF	12.76#
1194	M10-1.5 14 AF	12.85#
1193	M10-1.5 17 AF	25.52#
2006	M12-1.25 17 AF	23.90#
2188	M12-1.25 19 AF	37.40#
2189	M12-1.75 19 AF	38.06#
2191	M14-2.0	55.00#
3212	M16-2.0	65.95#

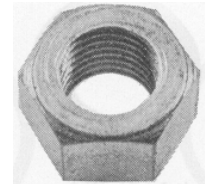
**STAINLESS STEEL JIS B1181-A2 (934-A2) TYPE 2 HEXAGON NUTS.**

2216	M2-0.4	0.25#
1196	M2.5 X 5 X 2	0.62#
4187	M2.6-0.45	0.60#
1197	M3 X 5.5 X 2.4	0.84#
1198	M4 X 7 X 3.2	1.79#
1199	M5 X 8 X 4	2.71#
2218	M6-1.0 X 10 X 5	5.50#
6084	M8-1.25 X 6.5 X13	9.04#
2219	M8-1.25 X 6.5 X 12	9.04#
3499	M10-1.25 X 14 X 8	12.26#
4143	M10-1.5 X 17 X 8 TYPE 1	12.26#
4478	M10-1.5X 14	12.26#

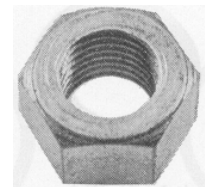
**BRASS, DIN 934/JIS B1181-2 HEXAGON NUTS, NICKEL PLATED**

2007	M3-0.5	0.84#
3701	M4X 7 X 3.2	1.79#
3702	M5X 8 X 4	2.71#

---

 SUPPLIER OF TOP NOTCH MERCHANDISE FOR OVER 20 YEARS