

SEIBU FASTENERS, INC.

10370 Slusher Dr. Unit 11 & 12

P.O. Box 4145

Santa Fe Springs, CA. 90670

Phone (562) 941-3348

Fax (562) 944-3621

TOLL FREE (866) 497-5344

STEEL, DIN 988 SHIM WASHERS, YELLOW ZINC PLATED.

1126	M10X 16 X 0.5	0.89#
------	---------------	-------

STEEL, DIN 9021 FENDER WASHERS, ZINC PLATED.

2399	M3X 9 X 0.8	0.77#
2400	M4X 12 X 1.0	1.69#
3698	M5X15X1.4	4.35#
1124	M6X 18 X 1.6	6.14#
2402	M6X 20 X 1.6	7.20#
1125	M12X 40 X 2.5	50.15#

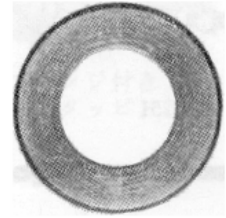
**STEEL, JASO F-203-68 SPRING SNAP PIN, ZINC PLATED. (SNAP)**

1211	D4X 60	0.48#
1212	D6X 100	0.88#
1213	D8 X 110	2.11#
1214	D10X 120	2.97#
1215	D12X 140	3.35#

**STEEL, JIS B1196 TYPE 1A HEXAGON WELD NUTS W/ PILOT, PLAIN. (WELD)**

2397	M4-0.7	6.82#
6214	M6-1.0X 13 X 6	10.74#

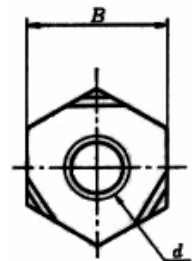
**STEEL, JIS B1181 (DIN 934-8) TYPE 2 HEXAGON NUTS, ZINC PLATED.**

1184	M2-0.4 X 4 X 1.6	0.31#
1185	M2.5 X 5 X 2	0.62#
1233	M2.6	0.60#
1186	M3-0.5 X 5.5 X 2.4	0.84#
1187	M3.5-0.6 X 6 X 2.8	0.95#
1188	M4 X 7 3.2	1.79#
1189	M5-0.8	2.71#
1190	M6-1.0 X 10 X 5	5.50#
2182	M7-1.0 X 5.5 X 11	5.92#
1191	M8-1.25 12 AF	11.00#
1192	M8-1.25 13 AF	11.44#
4926	M10-1.25 14 AF	12.76#
1194	M10-1.5 14 AF	12.85#
1193	M10-1.5 17 AF	25.52#
2006	M12-1.25 17 AF	23.90#
2188	M12-1.25 19 AF	37.40#
2189	M12-1.75 19 AF	38.06#
2191	M14-2.0	55.00#
3212	M16-2.0	65.95#

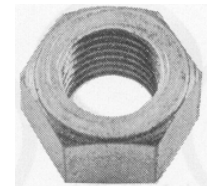
**STAINLESS STEEL JIS B1181-A2 (934-A2) TYPE 2 HEXAGON NUTS.**

2216	M2-0.4	0.25#
1196	M2.5 X 5 X 2	0.62#
4187	M2.6-0.45	0.60#
1197	M3 X 5.5 X 2.4	0.84#
1198	M4 X 7 X 3.2	1.79#
1199	M5 X 8 X 4	2.71#
2218	M6-1.0 X 10 X 5	5.50#
6084	M8-1.25 X 6.5 X13	9.04#
2219	M8-1.25 X 6.5 X 12	9.04#
3499	M10-1.25 X 14 X 8	12.26#
4143	M10-1.5 X 17 X 8 TYPE 1	12.26#
4478	M10-1.5X 14	12.26#

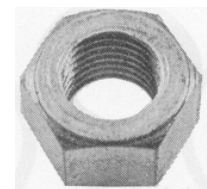
**BRASS, DIN 934/JIS B1181-2 HEXAGON NUTS, NICKEL PLATED**

2007	M3-0.5	0.84#
3701	M4X 7 X 3.2	1.79#
3702	M5X 8 X 4	2.71#

 SUPPLIER OF TOP NOTCH MERCHANDISE FOR OVER 20 YEARS

SEIBU FASTENERS, INC.

10370 Slusher Dr. Unit 11 & 12
P.O. Box 4145
Santa Fe Springs, CA. 90670

Phone (562) 941-3348
Fax (562) 944-3621
TOLL FREE (866) 497-5344

STEEL, DIN 439/JIS B1181 TYPE 3 HEXAGON JAM NUTS, ZINC PLATED

2275	M5	5.35#
2276	M6-1.0 X 10 X 3.6	6.00#
2277	M8-1.0 X 12 X 4	7.00#
577	M8-1.25 12 AF	7.60#
3774	M10-1.5 X 16 AF (I.F.L.)	12.60#
2284	M14-2.0 X 22 X 8	35.75#

STAINLESS STEEL, JIS B1181-3 HEXAGON JAM NUT, TYPE 3

5279	M8-1.25 13 AF	7.00#
------	---------------	-------

STEEL, JIS B1190, CLASS 8, HEX FLANGE NUT WITH OR WITHOUT SERRATION, ZINC PLTD.

SEIBU P/N	SIZE	WEIGHT PER/M
6320	M3-0.5	FL 8 1.18#
3660	M3-0.5 W/SERR	FL 8 1.52#
1114	M4-0.7 W/SERR	FL10 3.14#
1115	M4-0.7	FL10 3.00#
3505	M4-0.7 YZN	FL 10 3.00#
1116	M5-0.8	FL 12 3.08#
3790	M5-0.8 W/SERR	FL 12 3.08#
1117	M6-1.0	FL 14 8.03#
3358	M6-1.0 W/SERR	FL 13 6.63#
1118	M8-1.0 12-AF-	FL.17 12.88#
1119	M8-1.25 12-AF	FL 17 13.42#
1120	M8-1.25 12-AF W/SERR	FL 17 13.76#
1121	M10-1.0 14-AF	FL 19 18.45#
2012	M10-1.25 14-AF	FL 19 18.85#
4219	M10-1.25 -14-AF W/SERR	FL 19 18.85#
1122	M10-1.50 14-AF W/SERR	FL 19 18.40#
2169	M12-1.75 17-AF	FL 25

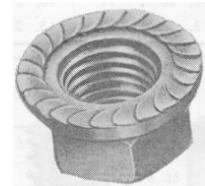

STEEL, JIS B1181-9, CLASS 9 HEXAGON NUT TYPE 2, ZINC PLATED

6282	M6-1.0 X 10	5.50#
------	-------------	-------

STEEL, JIS B1190 CLASS 10 HEXAGON FLANGE NUT W/OUT SERRATION, ZINC PLATED

SEIBU P/N	SIZE	WEIGHT PER/M
6221	M6-1.0-6H HRC 31 10.00 14.20 max 5.70-6.00 1.10 min	7.60#
6222	M8-1.25-6H HRC 31 13.00 17.90 max 7.60-8.00 1.20 min	12.75#
6223	M10-1.5-6H HRC 33 15.00 21.80 max 9.60-10.00 1.50 min	18.90#

STEEL, HEXAGON PANEL NUTS, ZINC PLATED.

1201	M6-0.75X 8 X 2	1.03#
312	M7-0.75 X 10 X 2	1.70#
3789	M7-0.75 X 9 X 2 YZN	1.70#
3142	M8-0.75 X 11 X 2	1.93#
5931	M8-0.75 X 11 X 2 YZN	1.93#
3311	M8-0.75 X 11 X 3 A2	2.90#
1203	M9-0.75 X 11 X 2	1.51#
5144	M9-0.75 X 11 X 2 YZN	1.51#
2964	M10-0.75 X 14 X 2	3.23#
3599	M10-1.0 X 14 X 2	3.22#
6194	M10-1.0 X 14 X 2 YZN	3.22#
6350	M11-0.75 X 14X2	3.22#
2252	M12-0.75 X 14 X 2	2.01#
1205	M12-1.0 X 14 X 2	2.16#
2991	M16-0.75 X 19 X 2.5	5.00#



STEEL, HEX PANEL FLANGE NUT ZINC DIECAST

1200	M9-0.75X11X14.3 FLANGE	1.42#
------	------------------------	-------