

SEIBU FASTENERS, INC.

10370 Slusher Dr. Unit 11 & 12
 P.O. Box 4145
 Santa Fe Springs, CA. 90670

Phone (562) 941-3348
 Fax (562) 944-3621
 TOLL FREE (866) 497-5344

STEEL, JIS B2808 SPRING PIN, TYPE W, PLAIN

STOCK	SEIBU P/N	SIZE	WEIGHT PER/M
	3587	M2.5X 10	0.52#
	3588	M2.5X 12	0.62#
	3589	M2.5X 16	0.82#
	3590	M2.5X 20	1.03#
	3591	M2.5X 22	1.13#
	3592	M2.5X 26	1.32#

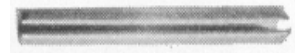

STEEL, JIS B1189 INDENTED HEXAGON HEAD FLANGE BOLTS TYPE 1&2
ZINC PLATED.

3783	M3-0.5 X 6 FL=7	HRB 83 T1 (+)	1.47 #
3271	M3-0.5 X 6 FL=8	HRB 83 T1 (+)	1.47#
5328	M3-0.5 X 8	HRB 71 T1 (+)	1.60#
3123	M4 X 10	HRB 90 T2	4.00#
3122	M4-0.7 X 12	HRB 82 T2	4.30#
3124	M4-0.7 X 16	HRB 85 T2	4.90#
3125	M4-0.7 X 20	HRB 79 T2	5.60#
3126	M4-0.7 X 22	HRB 85 T1	5.90#
3127	M4-0.7 X 25	HRB 84 T2	6.30#
6310	M4-0.7 X 30	HRB 84 T2	7.99#
6293	M5-0.8 X 10	HRB 86 T2	7.44#
6294	M5-0.8 X 12	HRB 90 T2	7.99#
6295	M5-0.8 X 16	HRB 92 T2	8.88#
6296	M5-0.8 X 20	HRB 88 T2	10.05#
3874	M6-1.0 X 10	HRB 98 6.8 T2	11.50#
4004	M6-1.0 X 10	HRC 26 8T2	11.50#
4005	M6-1.0 X 12	HRB 98	13.14#
3290	M6-1.0 X 12	HRC 27	13.14#
3876	M6-1.0 X 16	HRC 25 8.8 T2	13.50#
4201	M6-1.0 X 16	HRC 27 T1	13.64#
2141	M6-1.0 X 20	HRC 26 T2	14.72#
119	M6-1.0 X 25	HRC 26 8.8 T2	16.80#
123	M6-1.0 X 30	HRC 27 T2	19.70#
2446	M6-1.0 X 32	HRC 26 T2	19.80#
936	M6-1.0 X 35	HRC 28 ZN T2	20.66#
2142	M8-1.25 X 16	HRC 27 8.8 T2	26.50#

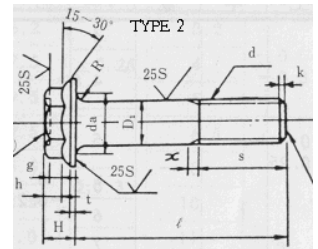
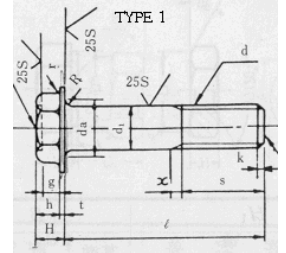

ALLOY STEEL, JIS B1189-10.9 SCM 435 INDENTED HEXAGON HEAD FLANGE BOLTS,
TYPE 1, BLACK PHOSPHATED.

SEIBU P/N	SIZE	WEIGHT PER/M
1003	M6-1.0 X 10 HRC 36	11.30#
2600	M6-1.0 X 12 HRC 33.5	13.14#
6333	M6-1.0 X 20 ZN HRC 32 T2	15.10#
6178	M6-1.0 X 20 HRC 35	15.12#
6179	M6-1.0 X 25 HRC 36	16.80#
2445	M6-1.0 X 30 HRC 32	18.42#
6180	M6-1.0 X 35 HRC 36	20.46#
6181	M6-1.0 X 40 HRC 37	22.12#
6229	M6-1.0 X 45 HRC 37	24.00#
6334	M8-1.25 X 16 ZNHRC 29 T2	26.98#
205	M8-1.25 X 20 ZNHRC 36 10.9 T2	28.75#
6183	M8-1.25 X 20 HRC 37	27.30#
6184	M8-1.25 X 25 HRC 36	31.00#
6185	M8-1.25 X 30 HRC 37	33.84#
2453	M8-1.25 X 35 ZNHRC 36 T2	37.98#
6186	M8-1.25 X 40 HRC 36	40.80#
6335	M8-1.25 X 45 ZNHRC 35 T2	44.74#
1970	M8-1.25 X 60 HRC 37	53.58#
6188	M8-1.25 X 70 HRC 37	59.27#
3572	M10-1.25 X 16 HRC 35	42.30#

SUPPLIER OF TOP NOTCH MERCHANDISE FOR OVER 20 YEARS

SEIBU FASTENERS, INC.

10370 Slusher Dr. Unit 11 & 12
 P.O. Box 4145
 Santa Fe Springs, CA. 90670

Phone (562) 941-3348
 Fax (562) 944-3621
 TOLL FREE (866) 497-5344

ALLOY STEEL, JIS B1189-10.9 SCM 435 INDENTED HEXAGON HEAD FLANGE BOLTS, TYPE 1, BLACK PHOSPHATED.

SEIBU P/N	SIZE	WEIGHT PER/M
5307	M10-1.25X 30 HRC 37	56.64#
5314	M10-1.25X 40 HRC 36	67.66#
2465	M12-1.25X 28 HRC 36 YZN	89.76#

STEEL, JIS B1180-7 HEXAGON BOLTS, SMALL ACROSS FLAT, ZINC PLATED.

SEIBU P/N	SIZE	WEIGHT PER/M
1605	M8-1.25X 16 12 AF	21.55#
1608	M8-1.25X 25 12 AF	27.90#
1609	M8-1.25X 30 12 AF	31.05#
1624	M10-1.25X 20 14 AF	40.50#
1626	M10-1.25X 30 14 AF	50.80#
1628	M10-1.25X 40 14 AF	63.80#
1646	M12-1.25X 40 17 AF	90.96#
3158	M12-1.75X 25 17 AF	73.55#
1591	M14-1.5X 60 22 AF(6.8)	124.26#
3067	M14-1.5X 60 22 AF(8.8) BLK DIN 961	124.26#

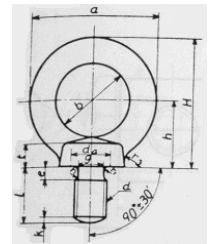
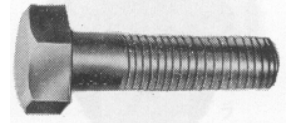

STEEL, JIS B1168 LIFTING EYE BOLT.

4019	M8 - 1.25X 13	118.15#
1207	M10-1.50X 17	134.80#
1208	M12-1.75X 22	255.35#
1210	M20-2.50X 30	1017.00#

STEEL, JCIS 10-70 TYPE 1, PRECISION HARDENED PAN HEAD MACHINE SCREW, DRIVE NO. 0, BLACK ZINC PLATED.

2193	M1.4-0.3 X 2	0.05#
3316	M1.4 -0.3 X 3	0.07#
5598	M1.4-0.3 X 3.5	0.08#
4150	M1.4-0.3 X 4	0.09#
4151	M1.4-0.3 X 5	0.10#
4152	M1.4-0.3 X 6	0.12#
4099	M1.6-0.35 X 3 ZN	0.09#
3117	M1.6-0.35 X 4 NICKEL	0.09#
2258	M1.6-0.35 X 6 NICKEL	0.09#
4153	M1.7-0.35 X 2	0.08#
4154	M1.7-0.35 X 3	0.10#
4155	M1.7-0.35 X 3.5	1.20#
4156	M1.7-0.35 X 4	1.31#
4157	M1.7-0.35 X 5	1.59#
4158	M1.7-0.35 X 6	1.89#
2259	M1.7-0.35 X 6 NICKEL	0.19#
4159	M2-0.4 X 2	0.12#
4160	M2-0.4 X 3	0.16#
2260	M2-0.4 X 3 NICKEL	0.17#
4161	M2-0.4 X 3.5	0.17#
4162	M2-0.4 X 4	0.20#
4163	M2-0.4 X 5	0.23#
4164	M2-0.4 X 6	0.27#
761	M2 -0.4 X 8	0.35#
904	M2.5 -0.45 X 6	0.49#
6076	M2.6-0.45 X 3	0.33#
6077	M2.6-0.45 X 4	0.39#
6078	M2.6-0.45 X 6 BLK ZN	0.53#
1384	M2.6-0.45X8 NICKEL	0.57#
6079	M2.6-0.45X10	0.78#
6083	M3-0.5 X 5 NICKEL	0.73#

