

SEIBU FASTENERS, INC.

10370 Slusher Dr. Unit 11 & 12
 P.O. Box 4145
 Santa Fe Springs, CA. 90670

Phone (562) 941-3348
 Fax (562) 944-3621
 TOLL FREE (866) 497-5344

ALLOY STEEL, JIS B1189-10.9 SCM 435 INDENTED HEXAGON HEAD FLANGE BOLTS, TYPE 1, BLACK PHOSPHATED.

SEIBU P/N	SIZE	WEIGHT PER/M
5307	M10-1.25X 30 HRC 37	56.64#
5314	M10-1.25X 40 HRC 36	67.66#
2465	M12-1.25X 28 HRC 36 YZN	89.76#

STEEL, JIS B1180-7 HEXAGON BOLTS, SMALL ACROSS FLAT, ZINC PLATED.

SEIBU P/N	SIZE	WEIGHT PER/M
1605	M8-1.25X 16 12 AF	21.55#
1608	M8-1.25X 25 12 AF	27.90#
1609	M8-1.25X 30 12 AF	31.05#
1624	M10-1.25X 20 14 AF	40.50#
1626	M10-1.25X 30 14 AF	50.80#
1628	M10-1.25X 40 14 AF	63.80#
1646	M12-1.25X 40 17 AF	90.96#
3158	M12-1.75X 25 17 AF	73.55#
1591	M14-1.5X 60 22 AF(6.8)	124.26#
3067	M14-1.5X 60 22 AF(8.8) BLK DIN 961	124.26#

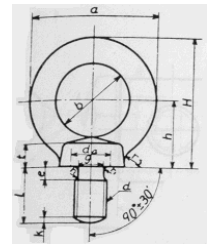
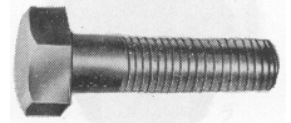

STEEL, JIS B1168 LIFTING EYE BOLT.

4019	M8 - 1.25X 13	118.15#
1207	M10-1.50X 17	134.80#
1208	M12-1.75X 22	255.35#
1210	M20-2.50X 30	1017.00#

STEEL, JCIS 10-70 TYPE 1, PRECISION HARDENED PAN HEAD MACHINE SCREW, DRIVE NO. 0, BLACK ZINC PLATED.

2193	M1.4-0.3 X 2	0.05#
3316	M1.4 -0.3 X 3	0.07#
5598	M1.4-0.3 X 3.5	0.08#
4150	M1.4-0.3 X 4	0.09#
4151	M1.4-0.3 X 5	0.10#
4152	M1.4-0.3 X 6	0.12#
4099	M1.6-0.35 X 3 ZN	0.09#
3117	M1.6-0.35 X 4 NICKEL	0.09#
2258	M1.6-0.35 X 6 NICKEL	0.09#
4153	M1.7-0.35 X 2	0.08#
4154	M1.7-0.35 X 3	0.10#
4155	M1.7-0.35 X 3.5	1.20#
4156	M1.7-0.35 X 4	1.31#
4157	M1.7-0.35 X 5	1.59#
4158	M1.7-0.35 X 6	1.89#
2259	M1.7-0.35 X 6 NICKEL	0.19#
4159	M2-0.4 X 2	0.12#
4160	M2-0.4 X 3	0.16#
2260	M2-0.4 X 3 NICKEL	0.17#
4161	M2-0.4 X 3.5	0.17#
4162	M2-0.4 X 4	0.20#
4163	M2-0.4 X 5	0.23#
4164	M2-0.4 X 6	0.27#
761	M2 -0.4 X 8	0.35#
904	M2.5 -0.45 X 6	0.49#
6076	M2.6-0.45 X 3	0.33#
6077	M2.6-0.45 X 4	0.39#
6078	M2.6-0.45 X 6 BLK ZN	0.53#
1384	M2.6-0.45X8 NICKEL	0.57#
6079	M2.6-0.45X10	0.78#
6083	M3-0.5 X 5 NICKEL	0.73#

