

**SEIBU FASTENERS, INC.**

10370 Slusher Dr. Unit 11 & 12  
 P.O. Box 4145  
 Santa Fe Springs, CA. 90670

Phone (562) 941-3348  
 Fax (562) 944-3621  
 TOLL FREE (866) 497-5344

**ALLOY STEEL, JIS B1189-10.9 SCM 435 INDENTED HEXAGON HEAD FLANGE BOLTS, TYPE 1, BLACK PHOSPHATED.**

SEIBU P/N	SIZE	WEIGHT PER/M
5307	M10-1.25X 30 HRC 37	56.64#
5314	M10-1.25X 40 HRC 36	67.66#
2465	M12-1.25X 28 HRC 36 YZN	89.76#

**STEEL, JIS B1180-7 HEXAGON BOLTS, SMALL ACROSS FLAT, ZINC PLATED.**

SEIBU P/N	SIZE	WEIGHT PER/M
1605	M8-1.25X 16 12 AF	21.55#
1608	M8-1.25X 25 12 AF	27.90#
1609	M8-1.25X 30 12 AF	31.05#
1624	M10-1.25X 20 14 AF	40.50#
1626	M10-1.25X 30 14 AF	50.80#
1628	M10-1.25X 40 14 AF	63.80#
1646	M12-1.25X 40 17 AF	90.96#
3158	M12-1.75X 25 17 AF	73.55#
1591	M14-1.5X 60 22 AF(6.8)	124.26#
3067	M14-1.5X 60 22 AF(8.8) BLK DIN 961	124.26#

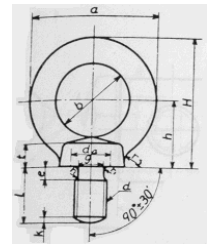
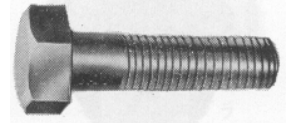

**STEEL, JIS B1168 LIFTING EYE BOLT.**

4019	M8 - 1.25X 13	118.15#
1207	M10-1.50X 17	134.80#
1208	M12-1.75X 22	255.35#
1210	M20-2.50X 30	1017.00#

**STEEL, JCIS 10-70 TYPE 1, PRECISION HARDENED PAN HEAD MACHINE SCREW, DRIVE NO. 0, BLACK ZINC PLATED.**

2193	M1.4-0.3 X 2	0.05#
3316	M1.4 -0.3 X 3	0.07#
5598	M1.4-0.3 X 3.5	0.08#
4150	M1.4-0.3 X 4	0.09#
4151	M1.4-0.3 X 5	0.10#
4152	M1.4-0.3 X 6	0.12#
4099	M1.6-0.35 X 3 ZN	0.09#
3117	M1.6-0.35 X 4 NICKEL	0.09#
2258	M1.6-0.35 X 6 NICKEL	0.09#
4153	M1.7-0.35 X 2	0.08#
4154	M1.7-0.35 X 3	0.10#
4155	M1.7-0.35 X 3.5	1.20#
4156	M1.7-0.35 X 4	1.31#
4157	M1.7-0.35 X 5	1.59#
4158	M1.7-0.35 X 6	1.89#
2259	M1.7-0.35 X 6 NICKEL	0.19#
4159	M2-0.4 X 2	0.12#
4160	M2-0.4 X 3	0.16#
2260	M2-0.4 X 3 NICKEL	0.17#
4161	M2-0.4 X 3.5	0.17#
4162	M2-0.4 X 4	0.20#
4163	M2-0.4 X 5	0.23#
4164	M2-0.4 X 6	0.27#
761	M2 -0.4 X 8	0.35#
904	M2.5 -0.45 X 6	0.49#
6076	M2.6-0.45 X 3	0.33#
6077	M2.6-0.45 X 4	0.39#
6078	M2.6-0.45 X 6 BLK ZN	0.53#
1384	M2.6-0.45X8 NICKEL	0.57#
6079	M2.6-0.45X10	0.78#
6083	M3-0.5 X 5 NICKEL	0.73#

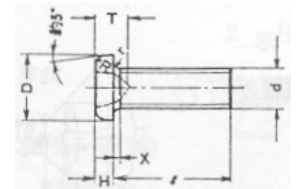

**SEIBU FASTENERS, INC.**

10370 Slusher Dr. Unit 11 & 12  
 P.O. Box 4145  
 Santa Fe Springs, CA. 90670

Phone (562) 941-3348  
 Fax (562) 944-3621  
 TOLL FREE (866) 497-5344

**STEEL, JCIS 10-70 TYPE 3, PRECISION HARDENED PAN HEAD MACHINE SCREW NO.0 BLACK ZINC PLATED.**

292	M1.4-0.3 X 2	0.08#
3328	M1.4-0.3 X 3	0.10#
2835	M1.4-0.3 X 3.5	0.11#
5970	M1.4-0.3 X 4	0.12#
5971	M1.4-0.3 X 4.5	0.14#
5972	M1.4-0.3 X 5	0.14#
4616	M1.4-0.3 X 5.5	0.14#
5973	M1.4-0.3 X 6	0.15#
3119	M1.7-0.35 X 2	0.13#
3633	M1.7-0.35 X 3	0.15#
3203	M1.7-0.35 X 3.5	0.16#
2254	M1.7-0.35 X 4 <b>NICKEL</b>	0.18#
3604	M1.7-0.35 X 4 <b>YZN</b>	0.18#
5974	M1.7-0.35 X 4	0.18#
5975	M1.7-0.35 X 4.5	0.19#
5976	M1.7-0.35 X 5	0.21#
3461	M1.7-0.35 X 5 <b>NICKEL</b>	0.21#
5981	M1.7-0.35 X 5.5	0.22#
5977	M1.7-0.35 X 6	0.23#
2263	M1.7-0.35 X 6 <b>NICKEL</b>	0.23#
5978	M2-0.4 X 2	0.19#
3109	M2-0.4 X 3	0.22#
2269	M2-0.4 X 3.5	0.24#
2264	M2-0.4 X 4	0.26#
5979	M2-0.4 X 4.5	0.03#
5980	M2-0.4 X 5	0.30#
794	M2-0.4 X 5.5	0.32#
4139	M2-0.4 X 6	0.34#
4623	M2-0.4 X 8	0.43#
827	M2-0.4 X 10	0.49#

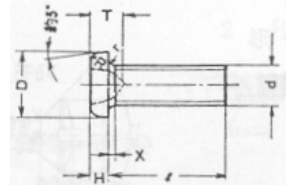

**STAINLESS STEEL, JCIS 10-70-A2 TYPE 1/TYPE 3 PAN HEAD MACHINE SCREW.**

6278	M1.6-0.35 X 3 <b>TYPE 3</b>	0.10#
4222	M1.7-0.35 X 2.5 <b>TYPE 1</b>	0.10#
4149	M1.7-0.35 X 4 <b>TYPE 1</b>	0.14#
49	M1.7-0.35 X 5 <b>TYPE 3</b>	0.21#

**STEEL, JCIS 10-70 PAN HEAD (+) FORMING TAPPING SCREW, TYPE B, NICKEL I**

3684	M1.4-0.3 X 4 <b>BFB1P</b>	0.75#
------	---------------------------	-------

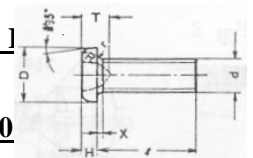

**STEEL, JCIS 10-70 PRECISION HARDENED OVAL HEAD MACHINE SCREW NO. 0**

2958	M1.6--0.35 X 6 <b>TYPE 1</b>	0.15#
3120	M1.7-0.35 X 4 <b>NICKEL TYPE 10.13#</b>	

**STEEL, JCIS 10-70 PRECISION HARDENED FLAT HEAD MACHINE SCREW NO. 0. BLACK ZINC PLATED TYPE 1.**

4922	M1.7-0.35 X 2.5 <b>NKL</b>	0.08#
3807	M1.7-0.35 X 3.5 <b>B-TITE NKL</b>	0.11 #
3110	M1.7-0.35 X 4 <b>NKL</b>	0.12#
2262	M1.7-0.35 X 6 <b>TYPE 3</b>	0.19#
1204	M1.7-0.35 X 10	0.25#
2270	M2-0.4 X 2.5	0.10#
2266	M2-0.4 X 4	0.16#
3481	M2-0.4 X 8	0.39#
863	M2.5-0.45 X 6	0.36#

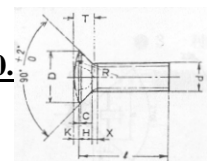

**STEEL, JCIS 10-70 PRECISION MACHINE SCREW, THIN PAN HEAD DRIVE NO. 1.**

6083	M3-0.5 X 5 <b>HD=5.25X10 NICKEL</b>	0.93#
------	-------------------------------------	-------

**STEEL, JIS B1122 (+) PAN HEAD THREAD FORMING SCREW, YELLOW**

SUPPLIER OF TOP NOTCH MERCHANDISE FOR OVER 20 YEARS

**SEIBU FASTENERS, INC.**

10370 Slusher Dr. Unit 11 & 12

P.O. Box 4145

Santa Fe Springs, CA. 90670

**ZINC PLTD. (P-TITE)**

Phone (562) 941-3348  
 Fax (562) 944-3621  
 TOLL FREE (866) 497-5344

5334	M2-0.794 X 3	0.23#
1236	M2-0.794 X 4	0.25#
3419	M2-0.794 X 4.5 <b>BLK ZN</b>	0.25#
2443	M2-0.794 X 5	0.29#
2198	M2-0.794 X 6	0.31#
5608	M2-0.794 X 8	0.38#
3209	M2-0.794 X 10	0.45#
5639	M2-0.794 X 12	0.50#
5653	M2.6-1.058 X 4	0.52#
5669	M2.6-1.058 X 5	0.59#
1332	M2.6-1.058 X 6	0.65#
5982	M2.6-1.058 X 8	0.75#
5983	M2.6-1.058 X 10	0.86#
5984	M2.6-1.058 X 12	0.98#
24	M2.6-1.058 X12 <b>BLK ZN</b>	0.98#
4620	M3-1.270 X 4	0.82#
5989	M3-1.270 X 5	0.88#
5990	M3-1.270 X 6 <b>Rohs</b>	0.95#
5991	M3-1.270 X 8	1.11#
5992	M3-1.270 X 10	1.25#
5993	M3-1.270 X 12	1.42#
5996	M3-1.270 X 16 <b>BLK ZN</b>	1.76#
5998	M3-1.270 X 20	2.10#
5999	M4-1.588 X 5	1.80#
6000	M4-1.588 X 6	1.93#
6001	M4-1.588 X 7	2.08#
6002	M4-1.588 X 8	2.17#
6003	M4-1.588 X 10	2.46#
6004	M4-1.588 X 12	2.72#
6005	M4-1.588 X 14	2.96#
6011	M4-1.588 X 30	5.19#



**STEEL, JIS B1122(+) PAN HEAD TAPPING SCREW TYPE "B", ZINC PLATED.**

3735	M3-1.270 X 6	0.98#
6153	M4-1.588 X 12 YZN	2.90#

**STEEL, JIS B1122(+) BIND HEAD THREAD FORMING SCREW, YELLOW ZINC. (P-TITE)**

4624	M2-0.794 X 3	0.30#
4651	M2-0.794 X 4	0.34#
4167	M2-0.794 X 5	0.37#
4177	M2-0.794 X 6	0.41#
4171	M2-0.794 X 8	0.46#
4181	M2-0.794 X 10	0.52#
4183	M2-0.794 X 12	0.60#
1219	M2.6-1.058 X 4	0.52#
98	M2.6-1.058 X 5	0.77#
4112	M2.6-1.058 X 6	0.78#
6012	M2.6-1.058 X 8	0.86#
6014	M2.6-1.058 X 12	1.09#
6019	M3-1.270 X 4	0.96#
6020	M3-1.270 X 5	1.00#
6021	M3-1.270 X 6	1.09#
6022	M3-1.270 X 8	1.25#
6023	M3-1.270 X 10	1.25#
6024	M3-1.270 X 12	1.48#

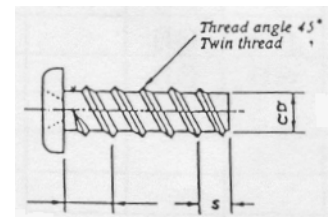

**STEEL, JIS B1122 (+) P-TITE FLAT COUNTERSUNK HEAD THREAD FORMING Z PLATED.**

6231	M3-1.270 X 8	1.25#
------	--------------	-------

**STEEL, JIS B1122 (+) TRUSS HEAD THREAD FORMING SCREW, YELLOW ZINC**

